



LEVEL



FLOW



PRESSURE



TEMPERATURE



ELECTRONICS



## Датчики уровня серии LINEAR – S

Архангельск (8182)63-90-72  
Астрахань (8512)99-46-04  
Барнаул (3852)73-04-60  
Белгород (4722)40-23-64  
Брянск (4832)59-03-52  
Владивосток (423)249-28-31  
Волгоград (844)278-03-48  
Вологда (8172)26-41-59  
Воронеж (473)204-51-73  
Екатеринбург (343)384-55-89  
Иваново (4932)77-34-06

Ижевск (3412)26-03-58  
Иркутск (395)279-98-46  
Казань (843)206-01-48  
Калининград (4012)72-03-81  
Калуга (4842)92-23-67  
Кемерово (3842)65-04-62  
Киров (8332)68-02-04  
Краснодар (861)203-40-90  
Красноярск (391)204-63-61  
Курск (4712)77-13-04  
Липецк (4742)52-20-81

Киргизия (996)312-96-26-47

Магнитогорск (3519)55-03-13  
Москва (495)268-04-70  
Мурманск (8152)59-64-93  
Набережные Челны (8552)20-53-41  
Нижний Новгород (831)429-08-12  
Новокузнецк (3843)20-46-81  
Новосибирск (383)227-86-73  
Омск (3812)21-46-40  
Орел (4862)44-53-42  
Оренбург (3532)37-68-04  
Пенза (8412)22-31-16

Казахстан (7273)495-231

Пермь (342)205-81-47  
Ростов-на-Дону (863)308-18-15  
Рязань (4912)46-61-64  
Самара (846)206-03-16  
Санкт-Петербург (812)309-46-40  
Саратов (845)249-38-78  
Севастополь (8692)22-31-93  
Симферополь (3652)67-13-56  
Смоленск (4812)29-41-54  
Сочи (862)225-72-31  
Ставрополь (8652)20-65-13

Таджикистан (992)427-82-92-69

Сургут (3462)77-98-35  
Тверь (4822)63-31-35  
Томск (3822)98-41-53  
Тула (4872)74-02-29  
Тюмень (3452)66-21-18  
Ульяновск (8422)24-23-59  
Уфа (347)229-48-12  
Хабаровск (4212)92-98-04  
Челябинск (351)202-03-61  
Череповец (8202)49-02-64  
Ярославль (4852)69-52-93

Единый адрес для всех регионов: [vck@nt-rt.ru](mailto:vck@nt-rt.ru) || <https://valco.nt-rt.ru/>

## GENERAL CHARACTERISTICS



The principle of operation is of potentiometric type, based on the gradual shutdown of a chain of resistors and reed contacts, placed inside the guiding rod, by a magnetic float. The only moving element is the float that moves, for buoyancy, along the measuring rod. This ensures a high degree of reliability.

- **Stainless steel – AISI 316**
- Measuring resolution 5 – 10 – 20 mm.
- Potentiometric signal output (**LC**).
- 4-20mA analog output (**LCT**).
- 0-5 / 0-10V analog output (**LCTV**).
- (0)4-20mA analog output with digital display (**LCO**).
- Up to 6m length.
- Maximum working pressure 50 Bar
- Operating ambient temperature -30/+55°C UR 90%.
- Standard working temperature up to 105°C.  
Executions up to 150°C on request.
- Minimum degree of protection IP65.
- Built-in temperature sensors, on request.  
PT – PTC – NTC.
- ATEX constructions (See Linear ATEX E – Linear ATEX I series)



See MULTISIGNAL

## FLOATS

Tab.1



	Stainless steel – AISI 316						
<b>Material</b>	Stainless steel – AISI 316						
<b>Specific gravity</b>	0,75	0,55	0,78	0,82	0,7	0,65	0,6
<b>Measuring resolution - mm</b>	5	5	20	10	5	10 – 20	10 – 20
<b>Max. bar</b>	30	10	15	10	50	40	15
<b>Max. °C - Class</b>	L = 105°C						
On request	R = 150°C						

## ELECTRICAL OUTPUT

Tab.2

W1	S1	S1	P1 - P2	P1 - P2	O1
IP65 Housing	DIN 43650 IP65 Plug	DIN 43650 IP65 Plug	P1 Brass cable-gland IP68 P2 Polyamide cable-gland IP67	P1 Brass cable-gland IP68 P2 Polyamide cable-gland IP67	OMNI electric head

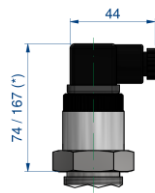
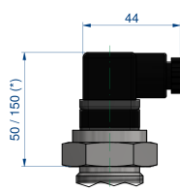
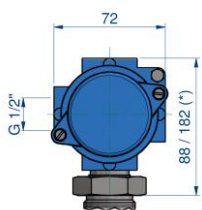

LC – LCT – LCTV	LC	LCT - LCTV	LC	LCT - LCTV	LCO
With heatsink – see dimension (*)		LCT – LCTV – LCO = Temperature class R			

## PROCESS CONNECTIONS

Tab.3

LC type P1-P2 output = Installation from inside		Float type	LC - LCT - LCTV - LCO type = Installation from outside						
10 3/8"	15 1/2"		25 1"	32 1-1/4"	40 1-1/2"	50 2"	FSHX Flange	DN65 Flange	DN125 Flange
All type of floats All type of thread		S29-32	G	G-C-N	G-C-N	-	•	-	-
		S40-41	-	-	G-C-N	G-C-N	-	•	-
		S52S	-	-	-	G-C-N	-	•	-
		S52	-	-	-	G-C-N	-	•	-
		S100	-	-	-	-	-	-	•

### Male thread

G	C	N
Parallel UNI 228/1	Conical UNI 7/1	Conical NPT

### Available materials

S
AISI-316

### DN = Available materials

S	C
AISI-316	Steel On request

### FLANGES Dimensions in mm.

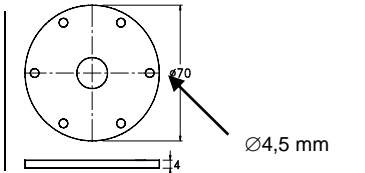

FSHX

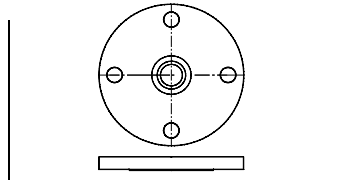

DN = UNI - DIN - ANSI Flanges

A Flanged connection  
A1 Threaded connection



## WIRING

### POTENTIOMETRIC OUTPUT

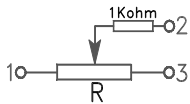

R = 1KΩ ÷ 15KΩ  
Depending on LM

### 4-20 mA OUTPUT

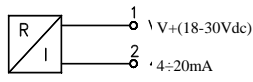

Max. load 500 Ω  
Power supply 18 ÷ 36 Vdc

### V OUTPUT

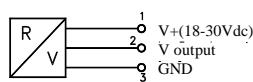

1	0 - 10	3	1 - 5
2	0 - 5	4	0,5 - 4,5

### 4-20 mA OUTPUT WITH DIGITAL DISPLAY

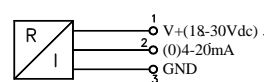

LC	LCT	LCTV..	LCO
----	-----	--------	-----

## DIMENSIONS mm.

Tab.4

The dimensions L0 and LM are referred to the stop of the fitting (A1) or flange (A) connection.  
Tolerance on dimension L0 and LM ± 3 mm.

	S29	S32	S40	S41	S52 (S)	S52	S100
A	15	15	15	10	25	35	50
A1	35	35	35	30	45	55	-
B	25	25	45	30	30	40	60

Damping tube	-	- S	- V
On request	-	AISI-316	PVC

## OPTION - Built-in temperature sensor

Only for LC type = On request, it is possible to install a temperature sensor located at the bottom of the rod inside the instrument.

PT100 - PT1000	PTC	NTC
EN 60751 - IEC 751	Resistance at 25°C ≤ 500 Ω	Resistance at 25°C 2-5-10-50-100 KΩ
Class B - (Class A on request)	Temperature 60°C ÷ 150°C	Precision ± 5% / ± 3% (on request)

## NOMENCLATURE

LC S52 10 1300 / 1400 S - S 50 G S W1 L 1,5 M

LC	S52	10	1300 / 1400	S	- S	50	G	S	W1	L	1,5 M	
•												Type: LC - LCT - LCTV - LCO
	•											Tab.1 Float
		•										Tab.1 Measuring resolution (mm).
			•									Tab.4 Measuring length LM / Total length L0 (mm).
				•								Tab.3 Rod material.
					•							Tab.4 Damping tube (option).
						•						Tab.3 Process connection dimension.
							•					Tab.3 Process connection thread.
								•				Tab.3 Process connection material.
									•			Tab.2 Electrical output.
										•		Tab.1 Temperature class.
											•	Tab.2 Cable length (P1 - P2) 1,5m / 3m, other lengths on request.



# LINEAR S



## Request form

### External mounting

### Internal mounting

W1

Electrical housing IP 65

S1

Plug IP65  
DIN 43650

P1

P1 Cable-gland brass IP68  
P2 Cable-gland polyamide IP67  
L cable.....mm

P2

C

Only internal mounting  
Cable L.....mm

LC/LCT

70

LC

LCT

LC

LCT

LC

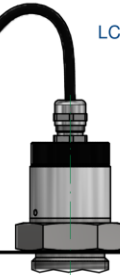
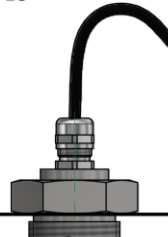
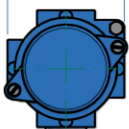

Liquid under control: .....

Specific gravity: .....

Maximum pressure: .....

Maximum temperature: .....

Approvals:



Measuring resolution:

5 mm

10 mm

20 mm

Process connection:

Threaded: .....

Flanged: .....

Material:

Brass

AISI-316

PVC

PP

PVDF

Electrical output:

3-wires potentiometer



2-wires potentiometer



Calibrated potentiometer

Empty tank = .....ohm

Full tank = .....ohm

4 ÷ 20 mA output

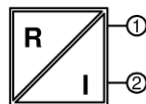

0.5 ÷ 4.5 V output

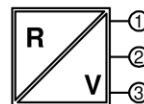

1 ÷ 5 V output

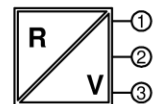

Total length  
L0 (mm)

Measuring length  
LM (mm)

0 ÷ 5 V output



0 ÷ 10 V output



## По вопросам продажи и поддержки обращайтесь:

**Архангельск** (8182)63-90-72  
**Астрахань** (8512)99-46-04  
**Барнаул** (3852)73-04-60  
**Белгород** (4722)40-23-64  
**Брянск** (4832)59-03-52  
**Владивосток** (423)249-28-31  
**Волгоград** (844)278-03-48  
**Волгода** (8172)26-41-59  
**Воронеж** (473)204-51-73  
**Екатеринбург** (343)384-55-89  
**Иваново** (4932)77-34-06

**Ижевск** (3412)26-03-58  
**Иркутск** (395)279-98-46  
**Казань** (843)206-01-48  
**Калининград** (4012)72-03-81  
**Калуга** (4842)92-23-67  
**Кемерово** (3842)65-04-62  
**Киров** (8332)68-02-04  
**Краснодар** (861)203-40-90  
**Красноярск** (391)204-63-61  
**Курск** (4712)77-13-04  
**Липецк** (4742)52-20-81

**Киргизия** (996)312-96-26-47

**Магнитогорск** (3519)55-03-13  
**Москва** (495)268-04-70  
**Мурманск** (8152)59-64-93  
**Набережные Челны** (8552)20-53-41  
**Нижний Новгород** (831)429-08-12  
**Новокузнецк** (3843)20-46-81  
**Новосибирск** (383)227-86-73  
**Омск** (3812)21-46-40  
**Орел** (4862)44-53-42  
**Оренбург** (3532)37-68-04  
**Пенза** (8412)22-31-16

**Казахстан** (7273)495-231

**Пермь** (342)205-81-47  
**Ростов-на-Дону** (863)308-18-15  
**Рязань** (4912)46-61-64  
**Самара** (846)206-03-16  
**Санкт-Петербург** (812)309-46-40  
**Саратов** (845)249-38-78  
**Севастополь** (8692)22-31-93  
**Симферополь** (3652)67-13-56  
**Смоленск** (4812)29-41-54  
**Сочи** (862)225-72-31  
**Ставрополь** (8652)20-65-13

**Таджикистан** (992)427-82-92-69

**Сургут** (3462)77-98-35  
**Тверь** (4822)63-31-35  
**Томск** (3822)98-41-53  
**Тула** (4872)74-02-29  
**Тюмень** (3452)66-21-18  
**Ульяновск** (8422)24-23-59  
**Уфа** (347)229-48-12  
**Хабаровск** (4212)92-98-04  
**Челябинск** (351)202-03-61  
**Череповец** (8202)49-02-64  
**Ярославль** (4852)69-52-93

Единый адрес для всех регионов: [vck@nt-rt.ru](mailto:vck@nt-rt.ru) || <https://valco.nt-rt.ru/>



LEVEL



FLOW



PRESSURE



TEMPERATURE



ELECTRONICS