



LEVEL



FLOW



PRESSURE



TEMPERATURE



ELECTRONICS



Датчики уровня взрывозащищенные стандарта АTEX I – ЕАС GOST серии MULTIPPOINT – V-F

Архангельск (8182)63-90-72
Астрахань (8512)99-46-04
Барнаул (3852)73-04-60
Белгород (4722)40-23-64
Брянск (4832)59-03-52
Владивосток (423)249-28-31
Волгоград (844)278-03-48
Вологда (8172)26-41-59
Воронеж (473)204-51-73
Екатеринбург (343)384-55-89
Иваново (4932)77-34-06

Ижевск (3412)26-03-58
Иркутск (395)279-98-46
Казань (843)206-01-48
Калининград (4012)72-03-81
Калуга (4842)92-23-67
Кемерово (3842)65-04-62
Киров (8332)68-02-04
Краснодар (861)203-40-90
Красноярск (391)204-63-61
Курск (4712)77-13-04
Липецк (4742)52-20-81

Киргизия (996)312-96-26-47

Магнитогорск (3519)55-03-13
Москва (495)268-04-70
Мурманск (8152)59-64-93
Набережные Челны (8552)20-53-41
Нижний Новгород (831)429-08-12
Новокузнецк (3843)20-46-81
Новосибирск (383)227-86-73
Омск (3812)21-46-40
Орел (4862)44-53-42
Оренбург (3532)37-68-04
Пенза (8412)22-31-16

Казахстан (7273)495-231

Пермь (342)205-81-47
Ростов-на-Дону (863)308-18-15
Рязань (4912)46-61-64
Самара (846)206-03-16
Санкт-Петербург (812)309-46-40
Саратов (845)249-38-78
Севастополь (8692)22-31-93
Симферополь (3652)67-13-56
Смоленск (4812)29-41-54
Сочи (862)225-72-31
Ставрополь (8652)20-65-13

Таджикистан (992)427-82-92-69

Сургут (3462)77-98-35
Тверь (4822)63-31-35
Томск (3822)98-41-53
Тула (4872)74-02-29
Тюмень (3452)66-21-18
Ульяновск (8422)24-23-59
Уфа (347)229-48-12
Хабаровск (4212)92-98-04
Хельсинки (351)202-03-61
Череповец (8202)49-02-64
Ярославль (4852)69-52-93

Единый адрес для всех регионов: vck@nt-rt.ru || <https://valco.nt-rt.ru/>

APPROVED IN ACCORDANCE WITH THE EUROPEAN STANDARD 2014/34/EU - ATEX



Safety barrier
See SAFE SW

Exia GOST-R Ex

These instruments, intrinsically safe certified:

CESI 03 ATEX 265 Ext.2 II 1G Exia IIC T4/T5/T6 Ga,
CESI 03 ATEX 265 Ext.2 II 1/2G Exia IIC T4/T5/T6 Ga/Gb,
are used to control the level of liquids or fuel in tanks, both underground and outdoors, installed in hazardous areas where flammable products are treated.

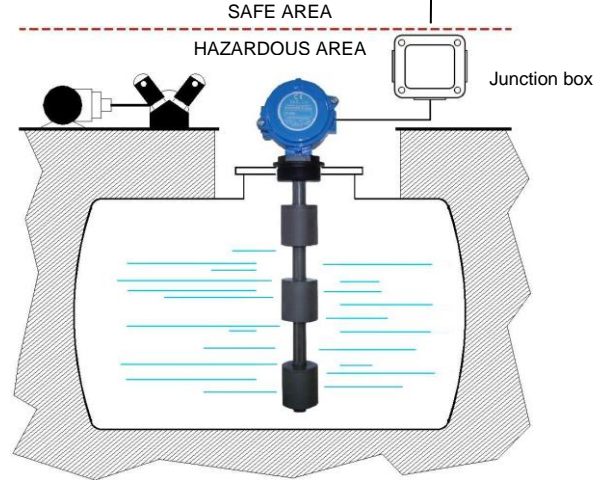

GENERAL CHARACTERISTICS

- **PVC – PP – PVDF**
- Up to 6 switch points.
- Up to 5 m length.
- Maximum working pressure 6 bar depending on used float.
- Standard working temperature up to 100°C.
- Executions up to 130°C on request.
- Operating ambient temperature
-40/+40°C = T6, -40/+55°C = T5, -40/+80°C = T4
- Minimum degree of protection IP65.

FLOAT

Tab.1

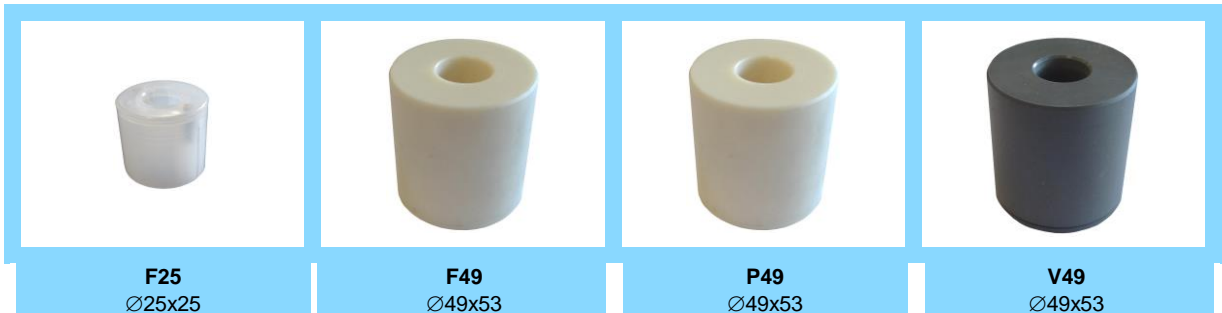

| | PVDF | | | | PP - Polypropylene | | | PVC | |
|---------------------------|---|-----------|---------------|----------|----------------------|----------|---------------|----------------------|--|
| | F25 Ø25x25 | | F49 Ø49x53 | | P49 Ø49x53 | | V49 Ø49x53 | | |
| Material | PVDF | | | | PP - Polypropylene | | | PVC | |
| Specific gravity | 0,65 | | 0,8 | | 0,45 | | | 0,7 | |
| Contact type | 3 | 7D | 4 | 7 | 4 | 7 | 4 | 7 | |
| Max N. of contacts | 4 | 3 | 6 | 6 | 4 | 3 | 4 | 3 | |
| Max. bar | 6 | | | | 3 | | | 6 | |
| Max. °C - Class | L = 100°C (T5) (T4) - N = 130°C (T4) | | | | D = 90°C (T6) | | | B = 60°C (T6) | |
| On request | N = 130°C (T6) (T5) | | | | - | | | - | |

ELECTRICAL CONTACTS

Tab.2

| TYPE | POWER | | | VOLTAGE | | CURRENT | |
|------|-----------|----|----|---------|-----|---------|-----|
| | VA | W | | AC | DC | AC | DC |
| SPST | 3 | 70 | 50 | 300 | 350 | 0,5 | 0,7 |
| SPST | 4 | 80 | 80 | 250 | 250 | 1,3 | 1,3 |
| SPDT | 7 | 60 | 60 | 230 | 230 | 1 | 1 |
| SPDT | 7D | 20 | 20 | 150 | 150 | 0,5 | 0,5 |

ELECTRICAL OUTPUT

Tab.3

| I1 | I2 | I3 | IS1 | IC1 - IC2 | IP1 - IP2 |
|-------------------|-------------------|----------------------|---------------------|--|--------------------------------------|
| IP65 housing (2G) | IP65 housing (2G) | IP66/67 housing (1G) | DIN 43650 IP65 (1G) | Cable IP65 (1G) | Cable-gland (1G) |
| 5 terminals | 18 terminals | 18 terminals | DIN43650 29x29 | IC1 Cable L = 1,5m IC2 Cable L = 3,0m | IP1 Brass IP68 IP2 Polyamide IP67 |

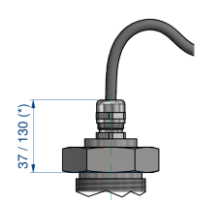
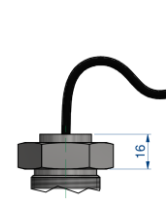
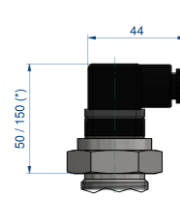
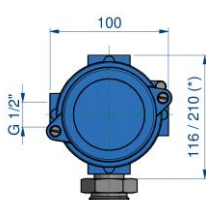
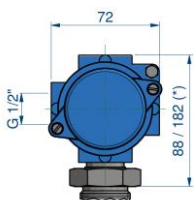

With heatsink - see dimension (*)

Temperature class **N = T6 - T5**

Temperature class **N = T4** heatsink not needed

PROCESS CONNECTIONS

Tab.4

| Installation from inside IC- IP output | | | | Float type | Installation from outside – available thread and flanges | | | | |
|--|------------|------------|------------|------------|--|--------------|----------|----------------|--------------|
| 06 1/8" | 08 1/4" | 10 3/8" | 15 1/2" | | 25 1" | 32 1 1/4" | 50 2" | F-HX Flange | DN Flange |
| All type of floats All type of thread | | | | F25 | G-C-N | G-C-N | - | • | • |
| | | | | F49 | - | - | G-C-N | - | • |
| | | | | P49 | - | - | G-C-N | - | • |
| | | | | V49 | - | - | G-C-N | - | • |

Male thread

| G | C | N |
|-----------------------|--------------------|----------------|
| Parallel UNI 228/1 | Conical UNI 7/1 | Conical NPT |

Available materials

| V | P | F | S |
|------------|----|------|----------|
| PVC | PP | PVDF | AISI-316 |
| On request | | | |

DN - Available materials

| V | S |
|------------|----------|
| PVC | AISI-316 |
| On request | |

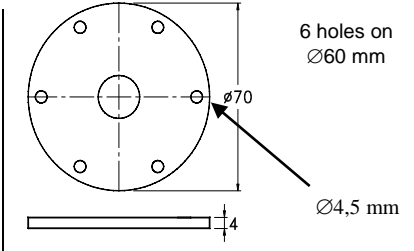

FVHX - FPHX - FFHX - FSHX

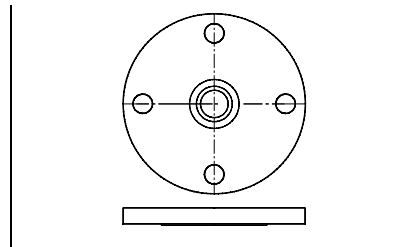

DN = UNI - DIN - ANSI Flanges

SAFETY BARRIERS

All Exia level controls must be electrically connected to the active or passive barriers according to the European Standard EN 50020. See technical bulletin SAFE SW.

A Flanged connection
A1 Threaded connection

WIRING

Tab.5

| I | Independent | Separately wired contacts | 1 | NO | Contacts status in no level conditions |
|---|-------------|---------------------------|---|----------|---|
| C | Common | Common wired contacts | 2 | NC | |
| S | Custom | Contacts wired on request | 3 | SPDT (*) | |

(*) Connected to barrier input just as NO or NC

SWITCH POINTS - minimum value in mm. Tab.6

The switch points L1 ÷ L6 are measured from the stop of the fitting or flange connection. General tolerances on switch points ± 3 mm.

| | Minimum distance in mm. | | | | | | | |
|------------------|-------------------------|----|-----|---|-----|---|-----|---|
| | F25 | | F49 | | P49 | | V49 | |
| A | 20 | | 40 | | 40 | | 40 | |
| A1 | 35 | | 60 | | 60 | | 60 | |
| B | 25 | | 40 | | 40 | | 40 | |
| C | 50 | | 80 | | 80 | | 80 | |
| Contact type | 3 | 7D | 4 | 7 | 4 | 7 | 4 | 7 |
| Max. N. contacts | 4 | 3 | 6 | 6 | 4 | 3 | 4 | 3 |

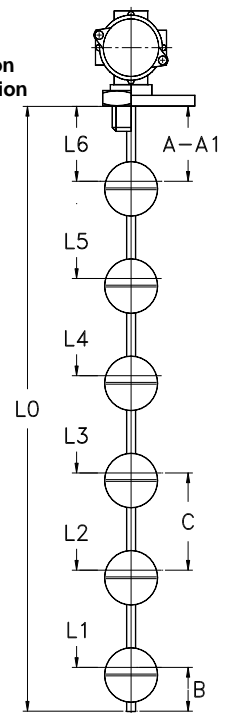

NOMENCLATURE

| M2 | V49 | 4 | 1300 | V | 50 | G | V | I1 | B | I22 | L1÷L6 | |
|----|-----|---|------|---|----|---|---|----|---|-----|-------|--|
| • | | | | | | | | | | | | Number of contacts S1 / M2÷M6 |
| | • | | | | | | | | | | | Tab.1 Float |
| | | • | | | | | | | | | | Tab.2 Electrical contact |
| | | | • | | | | | | | | | - Total length = L0 in mm. (See drawing) |
| | | | | • | | | | | | | | Tab.4 Rod material |
| | | | | | • | | | | | | | Tab.4 Process connection dimension |
| | | | | | | • | | | | | | Tab.4 Process connection thread |
| | | | | | | | • | | | | | Tab.4 Process connection material |
| | | | | | | | | • | | | | Tab.3 Electrical output |
| | | | | | | | | | • | | | Tab.1 Temperature class |
| | | | | | | | | | | • | | Tab.5 Wiring and contact status |
| | | | | | | | | | | | • | Tab.6 Switch points (mm) |

MULTIPOINT VF - ATEX I

Request form

External mounting

Internal mounting

I1 I2

Electrical housing IP 65
W1 max. 5 terminals 70mm
W2 max. 18 terminals 100mm

I3

Electrical housing IP 66/67
Stainless steel - AISI 316
Max. 18 terminals

IS1 IS2

Plug DIN 43650
29x29 or 15x15
Max 3 terminals

IP1 IP2

P1 Cable-gland IP68
P2 Cable-gland IP67
L cable.....mm

IC

Cable L.....mm

IC

Only internal mounting
Cable L.....mm

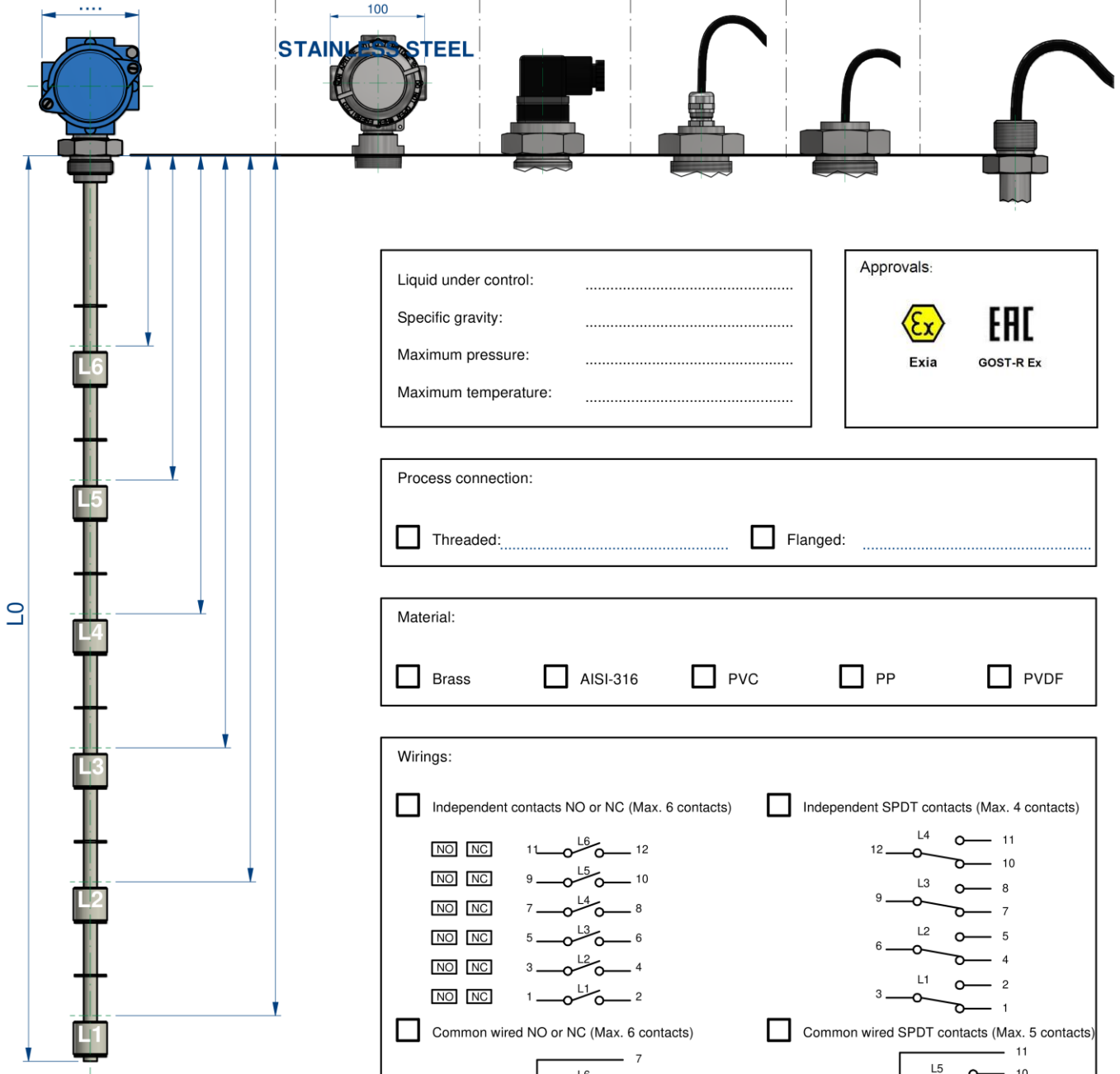

Total length
L0 (mm)

Liquid under control:

Specific gravity:

Maximum pressure:

Maximum temperature:

Approvals:



Exia



GOST-R Ex

Process connection:

Threaded: Flanged:

Material:

Brass AISI-316 PVC PP PVDF

Wirings:

Independent contacts NO or NC (Max. 6 contacts)

Independent SPDT contacts (Max. 4 contacts)

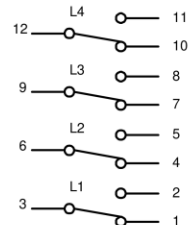
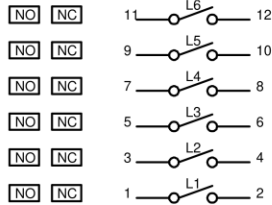

Common wired NO or NC (Max. 6 contacts)

Common wired SPDT contacts (Max. 5 contacts)

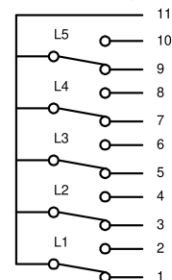
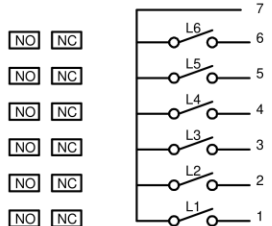

По вопросам продажи и поддержки обращайтесь:

Архангельск (8182)63-90-72
Астрахань (8512)99-46-04
Барнаул (3852)73-04-60
Белгород (4722)40-23-64
Брянск (4832)59-03-52
Владивосток (423)249-28-31
Волгоград (844)278-03-48
Волгода (8172)26-41-59
Воронеж (473)204-51-73
Екатеринбург (343)384-55-89
Иваново (4932)77-34-06

Ижевск (3412)26-03-58
Иркутск (395)279-98-46
Казань (843)206-01-48
Калининград (4012)72-03-81
Калуга (4842)92-23-67
Кемерово (3842)65-04-62
Киров (8332)68-02-04
Краснодар (861)203-40-90
Красноярск (391)204-63-61
Курск (4712)77-13-04
Липецк (4742)52-20-81

Киргизия (996)312-96-26-47

Магнитогорск (3519)55-03-13
Москва (495)268-04-70
Мурманск (8152)59-64-93
Набережные Челны (8552)20-53-41
Нижний Новгород (831)429-08-12
Новокузнецк (3843)20-46-81
Новосибирск (383)227-86-73
Омск (3812)21-46-40
Орел (4862)44-53-42
Оренбург (3532)37-68-04
Пенза (8412)22-31-16

Казахстан (7273)495-231

Пермь (342)205-81-47
Ростов-на-Дону (863)308-18-15
Рязань (4912)46-61-64
Самара (846)206-03-16
Санкт-Петербург (812)309-46-40
Саратов (845)249-38-78
Севастополь (8692)22-31-93
Симферополь (3652)67-13-56
Смоленск (4812)29-41-54
Сочи (862)225-72-31
Ставрополь (8652)20-65-13

Таджикистан (992)427-82-92-69

Сургут (3462)77-98-35
Тверь (4822)63-31-35
Томск (3822)98-41-53
Тула (4872)74-02-29
Тюмень (3452)66-21-18
Ульяновск (8422)24-23-59
Уфа (347)229-48-12
Хабаровск (4212)92-98-04
Челябинск (351)202-03-61
Череповец (8202)49-02-64
Ярославль (4852)69-52-93

Единый адрес для всех регионов: vck@nt-rt.ru || <https://valco.nt-rt.ru/>



LEVEL



FLOW



PRESSURE



TEMPERATURE



ELECTRONICS